

A R-O-C-K-H

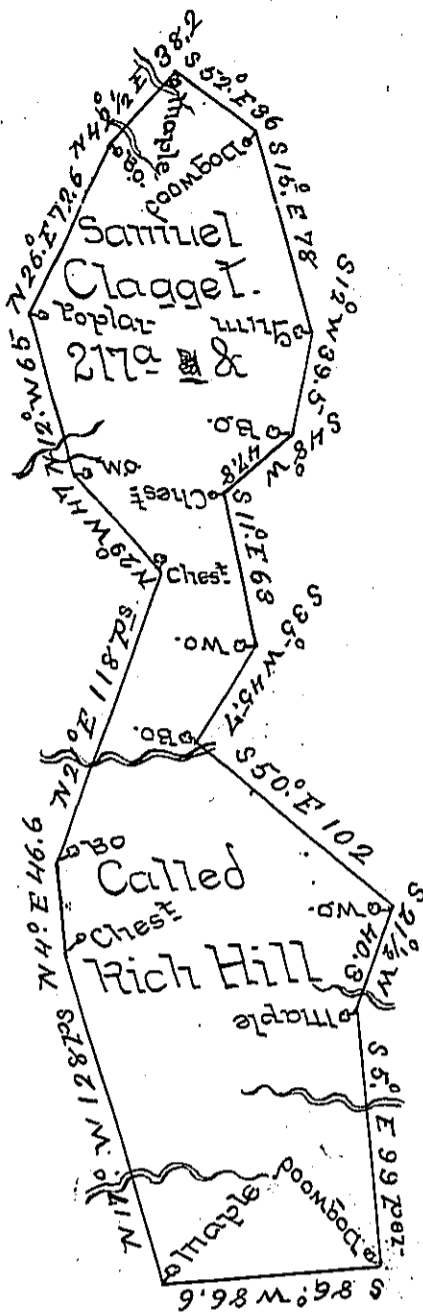

SIX-O-N-E-Y  
TWO-O-U-N-T-K-I-N

Situated on the Ridge that Divides Laurel Run from the Great Meadow Run about Two Miles Southward of the Falls of Youghiogoni River in Wharton Township Fayette County and Survey'd the tenth Day of March 1785. in Pursuance of a Warrant Dated the Eighteenth Day of February 1785.

By Alexander McClean Dep<sup>y</sup>

John Luters Esq<sup>t</sup>  
Surveyor General

*IN TESTIMONY* that the above is a copy of the original remaining on file in the Department of Internal Affairs of Pennsylvania, made conformably to an Act of Assembly approved the 16th day of February, 1833, I have hereunto set my Hand and caused the Seal of said Department to be affixed at Harrisburg, this second day of May 1899.

*James W. Pitta*  
Secretary of Internal Affairs.